

AMCO INDUSTRIAL VALVES



Forged Steel Globe Valve Class - 800

DATE: 13 - 06 - 07

REF: DRG. NO GTV - 17 - 0650

General Arrangement

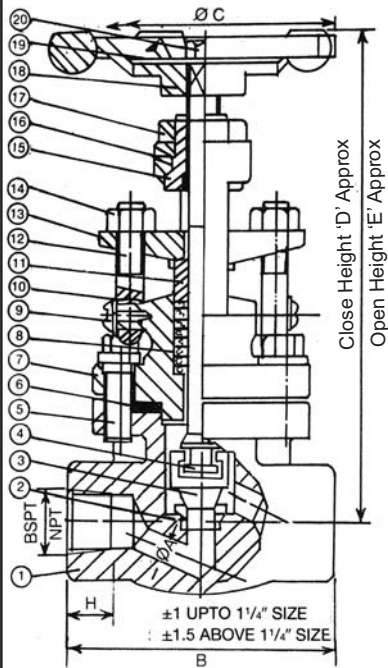

No	Description	Qty	Material	Specification	Remarks
1	Body	1	Forged Carbon Steel	ASTMA 105	
2	Seat Ring	1	Stainless Steel	AISI 410	Hardness 270 - 300 HB
3	Plug	1	Stainless Steel	AISI 410	Hardness 350 - 475 HB
4	Spindle	1	Stainless Steel	AISI 410	Hardness 220 - 250 HB
5	Collar Bolt / Hex	4	Alloy Steel	ASTM A 193 Gr B7	
6	Gasket	1	Spiral Wound Stainless Steel with Asbestos Filler	AISI 304	
7	Bonnet	1	Forged Carbon Steel	ASTMA 105	
8	Packing	As Req.	High Quality Graphited Lubricated ASbestos Material with Alloy wire Reinforcement		
9	Set Screw	2	Carbon Steel		Galvanised
10	Washer	2	Carbon Steel		Galvanised
11	Gland Bush	1	Stainless Steel	AISI 410	
12	Eye Bolt	2	Forged Carbon Steel	ASTMA 182 Gr F6	
13	Glanded Flange	1	Forged Stainless Steel	ASTMA 105	
14	Eye Bolt Nut	2	Carbon Steel		
15	Yoke Nut	1	Ni Resist Nodular CI	ASTMA 182 Gr. Gr D2	
16	Grub Screw	1	Carbon Steel		
17	Nut	1	Carbon Steel		
18	Hand Wheel	1	Malleable Iron	IS 2108 Gr B	
19	Name Plate	1	Anodised Aluminium		
20	Hand Wheel Nut	1	Carbon Steel		

Replacement of Packing is Possible in fully Open Valve

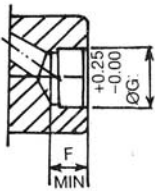

Technical Data

Design Code	Applicable Requirement	End Connection	Socket Weld	
			BS 5352	ANSI B 16.11
	BS 3808		IS 4712	
	API 602		ANSI B 2.1	
			BS 21	
			IS 554 / 554 T	
			Butt Welding	ANSI B 16.25
Testing Code	IBR	Pressure Temp Rating	ANSI B 16.5	
			API 602	
			BS 2995	
	ANSI B 16.5			
	BS 5146			

These Valves are available with Forged Alloy Steel ASTM A 182 GR F5 F11 F 304 F 316 and Trimmed SS 316 SS 304 with or Without Hard Facing (Stellite) Seat.

Hydrostatic	Body	3000 PSIG
Test Pressure	Seat	2200 PSIG
Pneumatic Test	Seat	80 PSIG
Primary Service	800 PSIG AT 850 ° F	

Size	A	B	C	D	E	F	G	H	Code	Approx (Wgt Kg)
6	6.4	85	85	150	156	9.5	14.0	10.2	011 GTV	2.50
10	6.4	85	85	150	156	9.5	17.5	10.2	012 GTV	2.30
15	9.5	85	85	150	156	9.5	21.7	13.5	013 GTV	2.00
20	12.7	92	85	160	167	12.7	27.0	13.8	014 GTV	2.65
25	17.6	101	85	180	190	12.7	33.8	17.3	015 GTV	4.00
40	28.5	127	145	245	255	12.7	48.6	18.3	016 GTV	11.00
50	30.1	140	145	245	255	15.9	61.1	19.2	017 GTV	16.00

(All Dimensions in mm)

Customer _____
 Order No: _____
 Job / Project _____

Manufactured By : **AMCO INDUSTRIAL VALVES, ROYAPURAM, CHENNAI - 600 013, INDIA.**

Due to continuous development programme, the design and data given in this leaflet are subject to change without prior notice.

REV

For Record

For Approval