

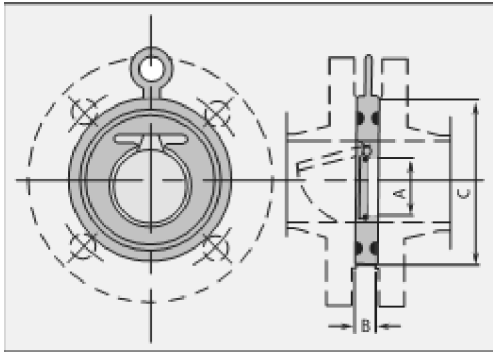

AMCO INDUSTRIAL VALVES	Drg. No. 8LWCV	Date: 8.12.09
------------------------	----------------	---------------



Body & Disc	Cast Iron IS 210 Gr. FG 260 Cast Steel ASTM A216 Gr. WCB Cast Stainless Steel ASTM A351 Gr. CF8/CF8M AISI 304 & 316
Seat/Body 'O' Rings	Nitrile, EPDM, Viton & Silicon

DN	25	40	50	65	80	100	125	150	200	250	300	350	400	450	500	600
A	15	24	30	40	52	71	93	114	157	195	230	270	310	360	406	490
B	12	12	14	14	14	14	16	19	28	28	38	41	51	51	60	70
C (Table D)	68	85	98	111	130	162	193	219	276	336	387	448	499	562	619	730
C (PN 10)	73	94	109	129	144	164	194	220	275	330	380	440	491	541	596	698
C (PN 16)	73	94	109	129	144	164	194	220	275	331	386	446	498	558	620	737
C (ASA 150)	65	84	103	123	136	174	195	220	278	340	410	451	511	549	606	770

CUSTOMER: _____

ORDER NO: _____

JOB/PROJECT: _____

MANUFACTURED BY: AMCO INDUSTRIAL VALVES, CHENNAI – 600 013, INDIA.

